



CL20

Aora

兒童智能吸頂燈

User Guide

**English**

**繁體中文**

BenQ.com

© 2025 BenQ Corporation.  
All rights reserved. Rights of modification reserved.

## Package Contents

Check the packaging for the following items. If any is missing or damaged, please contact the place of purchase immediately.

- Ceiling light x 1
- Upper bracket assembly (black, with metal plate) x 1
- Lower bracket (white) x 1
- Remote control x 1
- Remote control holder x 1
- Long screw (pointed tip) x 2
- Short screw (flat tip) x 2
- Expansion bolt (white) x 2
- AAA battery x 2
- Quick Start Guide x 1
- Warranty Information x 1



**The illustrations in this guide are for your reference only and may look different from the appearance of the product you purchased.**

## For Your Safety

This product has been tested and certified under regulations and standards for illuminating devices. To ensure your safety, please pay attention to the warnings and cautions below, and follow the instructions in this guide when installing and using the product.

- The applicable power supply specification of this product is 100-240V AC, 50/60Hz. Use only the genuine upper and lower brackets. Use of non-genuine upper and lower brackets may cause damages to the product.
- The applicable temperature of this product is 5°C-40°C. If the ambient temperature is too high or the time of use is too long, the product life will be shortened.
- Remove the packaging materials attached to this product before use. If the packaging material of this product is not completely removed, it may cause a fire when the product is in use.
- Once the light source needs to be replaced (such as when the life of the light source is over), please contact the manufacturer or its service agent for replacement.
- To prevent burns caused by the high temperature, do not put your hands behind the product when the light is on.
- If this product will not be used for a long period of time, turn off the mains power or the wall switch.
- Depending on the material and structure of the ceiling, the surface of the ceiling where this product is installed may become discolored.
- Avoid using this product in places where corrosive gases are generated, such as hot spring areas.
- Due to the expansion and contraction of the parts, cracking sounds may be heard when turning on the light or just after turning it off.
- When you shoot with a camera or video camera under the lighting of this product, lines or patterns may appear on the monitor or on the captured image.
- Do not disassemble any components of this product to avoid electric shocks or damages to the components.
- To avoid fire, do not place heat-generating electrical appliances or equipment (such as a stove or a furnace) directly under this product.
- The surface temperature of this product becomes high after prolonged use. If it is necessary to wipe and clean the surface of this product, please turn off the product and wait for it to cool down before proceeding.



- In case of the following situations, turn off the mains power immediately and contact the authorized service center or a qualified service person for inspection or repair:
  - When the outer casing of the light is broken
  - When there are strange odors coming from the light
  - When the light flickers
  - When the insulation of the light's wiring is damaged or frayed, and the metal strings inside can be seen
- Do not use the light in a humid environment (like in a bathroom or outdoors). Otherwise the components inside may short-circuit and result in accidents.
- This light is designed for indoor use only. Do not use it outdoors.
- Never disassemble the light or remove any components from it, as doing so may result in accidents and will void the product warranty.

## Components and Functions

### Parts for Installation Ceiling Light

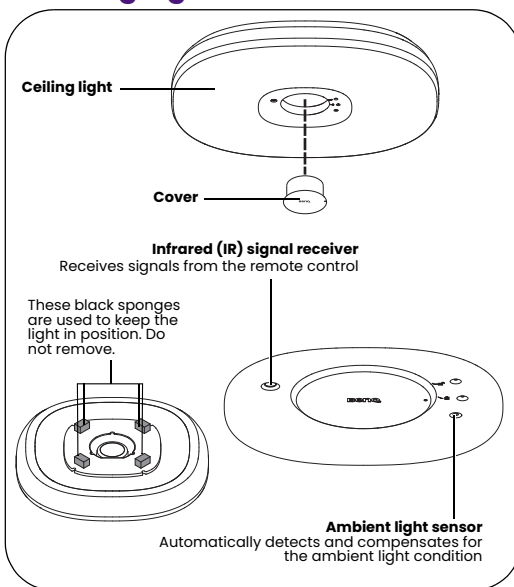
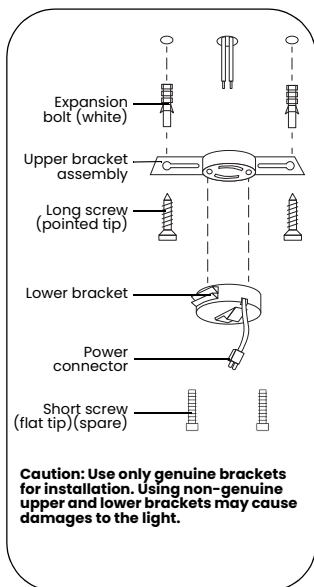

## Remote Control and Accessories

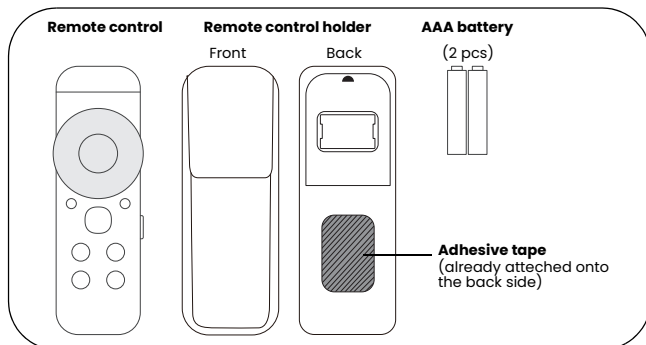

## Installing the Light

### Precautions for Installation

- This product must be installed by a professional electrician wearing appropriate protective equipment.
- Before installing this product, be sure to turn off the mains power and the wall switch to avoid accidents of electric shock or conduction.
- Do not install on weak ceilings (such as plywood or plasterboard ceilings) to avoid personal injury caused by falling.
- Use only genuine upper and lower brackets for installation. Do not use non-genuine upper and lower brackets. Other lamps (including its lower bracket) cannot be installed on the bracket of this product. Consult professional electricians for the proper process and method of installation of the genuine upper and lower brackets.
- If the use of a ladder is required when installing this product, be sure to pay attention to the stability of the ladder to avoid danger caused by the ladder tipping over.
- If the use of an extension cord (for electric tools) when installing this product, be sure to pay attention to its extendable length, so as to prevent the installer from being tripped by the extension cord and causing danger.
- The specified power supply specification of this product is 100-240V AC, 50/60Hz.
- This product is intended for installation on level and flat ceiling surfaces only. Do not install this product on sloping or uneven ceiling surfaces (such as inverted-V shaped/slanted ceilings, grid ceilings, ceilings with partitions and ceilings with extreme protrusions), so as not to fall and damage the product because it cannot be fixed securely.

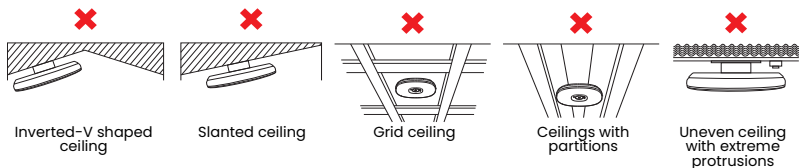

- Be sure to install the product on the ceiling surface using the mounting accessories supplied with the product, and ensure that the ceiling is strong enough to bear the weight of the product (approximately 4.1 kg). Do not install this product on a decorative surface (e.g. unreinforced ceilings, plywood or plasterboard), or use only glue to attach the product to the ceiling surface, as it may fall and cause a hazard because it cannot be secured securely.

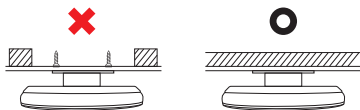

- To maintain ideal lighting effects, ensure that there is enough space (at least 84 cm in diameter) between the position of the upper bracket and the surrounding walls.

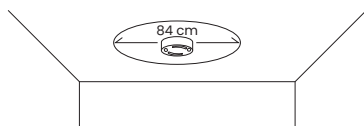

- This product must be used with a non-dimmable wall switch. If the wall switch is a dimming switch, please have a professional electrician replace it with a non-dimming wall switch to prevent abnormal operation.

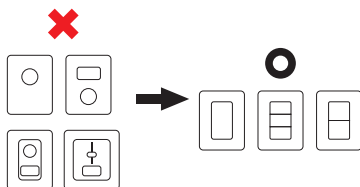

- If there are lighting devices with rectifiers nearby, please reserve a space of 150 cm in between.

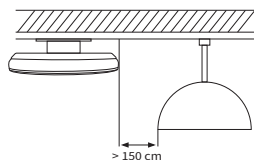

- Do not install the upper bracket if the situation below occurs. Contact BenQ customer service for replacement.
  - The upper bracket is damaged
  - The upper bracket becomes loose
  - The upper bracket has been installed on ceilings with partitions
- To prevent fires, do not cover the brackets with paper or cloth.

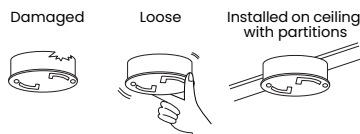

## Installation of the Upper and Lower Brackets

Before installing the brackets, be sure to turn off the mains power and the wall switch to avoid accidents of electric shock or conduction. Follow the steps below to avoid the danger of lamps falling due to improper installation.

1. Connect the upper bracket assembly to the AC power supply (100–240V AC, 50/60Hz). The neutral and live wires should be single-core wires with a suitable diameter of 1.6–2.0 mm, and the stripping length should be up to 10mm. Insert the neutral wire into the socket with a "W" mark, and the live wire into the socket without the mark. Ensure that the wires are inserted all the way into the wire sockets and firmly secured with no looseness, and that the copper portions are not exposed.

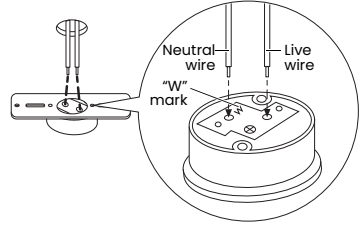

2. Secure the upper bracket assembly to the ceiling surface using the two long screws and plastic bolts.

- **To prevent the risk of falling, do not install the upper bracket assembly on a junction box.**
- **Do not use the existing holes to install the upper bracket assembly. Be sure to drill new holes during installation to prevent the risk of falling.**

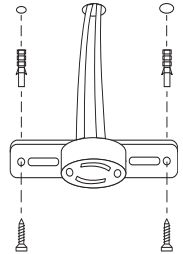

3. Align and insert the two metal hooks on the lower bracket into the two square holes on the upper bracket (1). Turn the lower bracket to the right (clockwise, as indicated by the green

arrow mark (2), until the red

button on the lower bracket is aligned with the red positioning sticker (3) of the upper bracket. If you hear a "click" sound at this time, it means that the lower bracket has been installed in place. If there is no "click" sound, or the lower bracket is loose after installation, check whether the metal hooks have been inserted into the square holes.

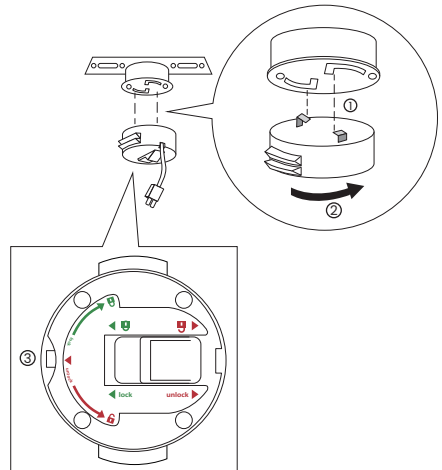

- **If you do not hear the "click" sound, or if the lower bracket is loose after installation, contact the customer service center for inspection.**

# Installation of the Ceiling Light

**Perform the installation correctly in order to prevent personal injuries caused by the fall of the ceiling light.**

1. Remove the cover in the center of the ceiling light. Rotate the cover counterclockwise until you hear a "click" sound (1). Make sure that the concave point on the cover is aligned with the unlock symbol (2), and then remove the cover (3).
2. Align the mounting hole in the center of the ceiling light with the center of the ceiling light with the lower bracket. Pass the power cord from the lower bracket through the mounting hole (1), then push the ceiling light all the way up against the lower bracket. At this time, if you hear a "click" sound twice, it means that the ceiling light has been installed in place.

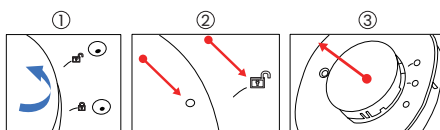

**Check the installation of the ceiling light and ensure that the following conditions do not occur:**

The light shakes easily    The light rotates easily

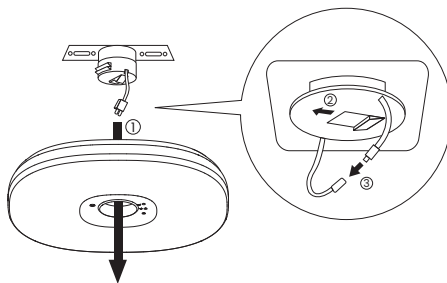

3. Hold the ceiling light with one hand and use the other hand to slide the green button on the lower bracket to the direction indicated by the green arrow mark **lock** (2) to lock the tenon and avoid the risk of falling.
4. Connect the power cord from the lower bracket to the power connector (3) of the ceiling light, and ensure that the power cord is firmly connected and there is no looseness.
5. Reinstall the cover. Align the concave point on the cover with the unlock symbol (1). Push the cover all the way up and ensure that the cover can be rotated but will not fall off. Turn the cover clockwise until you hear a "click" sound (2) and ensure that the concave point on the cover is aligned with the lock symbol (3).
6. Adjust the angle and test the functions of the ceiling light. Clean the outer casing of the ceiling light if necessary.

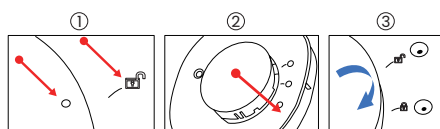

# Detaching the Ceiling Light

If the ceiling light needs to be detached for cleaning or maintenance, follow the instructions below.

## Precautions

- If the use of a ladder is required, be sure to pay attention to the stability of the ladder to avoid danger caused by the ladder tipping over.
- Turn off the mains power and the wall switch first to avoid accidents of electric shock or conduction.

## Detaching the Ceiling Light

1. Remove the cover in the center of the ceiling light. Rotate the cover counterclockwise until you hear a "click" sound (1). Make sure that the concave point on the cover is aligned with the unlock symbol (2), and then remove the cover (3).
2. Press down on the retaining hook on the power cord connector with your finger (1) and unplug the power cord connector (2) at the same time.
3. Hold the ceiling light with both hands and use your thumb to slide the green button on the lower bracket to the direction indicated by the red arrow mark **unlock** (3) to release the locking of the tenon. At this time, the ceiling light will be released from the lower bracket. Slowly remove the ceiling light and place it on a clean and stable surface.

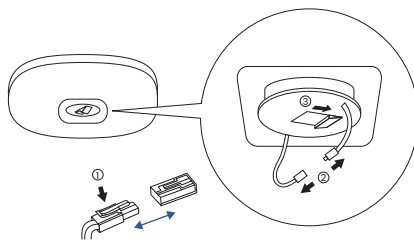
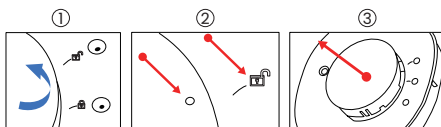

 **Be sure to support the ceiling light with both hands before releasing the tenon lock to prevent the light from falling and causing personal injury.**

## Detaching the Lower Bracket

If it is necessary to detach the lower bracket, detach the ceiling light first, then press the red button (1) on the lower bracket and turn the lower bracket to the left (counterclockwise, as indicated by the red arrow mark

) (2) at the same time.

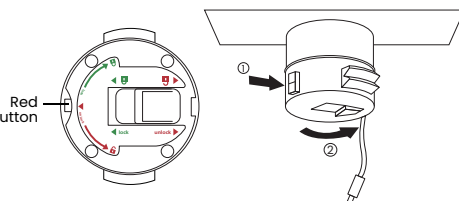



# Using the Ceiling Light

## Lighting Modes of the Ceiling Light

This ceiling light provides four lighting modes and a My Favorite mode which can be customized with lighting settings:

Lighting mode	Settings			Note
	Color temperature	Brightness	Lighting area	
Full Mode	4000K	100%	Main light source + indirect light source	In this mode, you can manually adjust the brightness and color temperature of the main and indirect light sources at the same time (when adjusting, it will exit the Full Mode)
Casual Mode	3000K	Automatically optimized according to the brightness of the surrounding environment	Indirect light source	In this mode, you can manually adjust the brightness and color temperature of the indirect light source (when adjusting, it will exit the Casual Mode).
Reading Mode	4500K		Main light source + indirect light source	In this mode, you can manually adjust the brightness and color temperature of the main and indirect light sources (when adjusting, it will exit the Reading Mode).
Night Light Mode	1800K	Adjustable in 10 levels (default: the 5th level)	Night lamp	Only brightness can be adjusted.
My Favorite Mode	<ul style="list-style-type: none"> <li>When My Favorite Mode is not set, press the My Favorite button on the remote control and the ceiling light will make a "beep" sound.</li> <li>To set up My Favorite Mode: After adjusting to the preferred light setting, press and hold the My Favorite button on the remote control, and the ceiling light will make a "beep" sound twice indicating that the setup is complete.</li> </ul>			

## Operation of the Ceiling Light

You can use the ceiling light in the following ways of operation:

- Using the wall switch (functions partially available)
- Using the remote control (functions partially available)
- Using the BenQ SmartLighting APP (full functions)

### Using the Wall Switch

You can use the wall switch to turn the ceiling light on or off, or cycle through the lighting modes between My Favorite Mode, Casual Mode and Night Light Mode. To change the lighting mode of the ceiling light, use the wall switch to turn off and then turn on the light within 3 seconds. Repeat this off > on operation to switch to the next lighting mode.

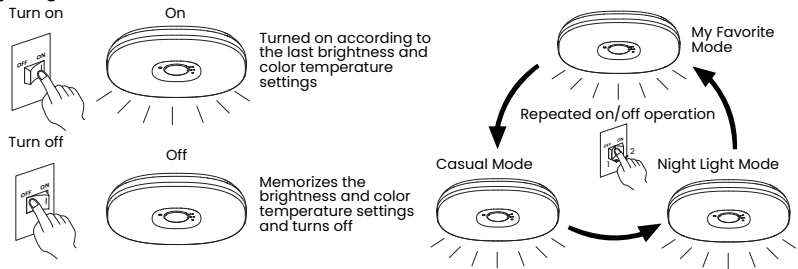

- If the power supply is suddenly interrupted when the wall switch is turned on, the ceiling light will automatically resume the settings before the power outage when the power is restored.
- If the ceiling light was turned on before the power outage, the ceiling light will automatically light up when the power is restored and resume the brightness and color temperature settings before the power outage.
- If the ceiling light has been turned off using other control methods (APP/voice control/remote control) before the power outage, the ceiling light will remain off when the power is restored. To turn on the ceiling light, you need to turn on and off the wall switch twice within 3 seconds, or use other control methods (APP/voice control/remote control).
- Do not operate more than two ceiling lights with a single wall switch, as it may not be possible to synchronize the operations at the same time.

## Using the Remote Control

### Installing Batteries

Insert the included two AAA batteries into the remote control. When inserting the batteries, make sure that the positive and negative polarities of the batteries match the markings on the remote control.

1. Open the back cover of the remote control. Press and hold the arrow mark on the back cover of the remote control (1), then slide it downward to open the back cover (2).
2. Insert 2 AAA batteries according to the markings on the battery compartment of the remote control.
3. Slide the back cover upward to close it.

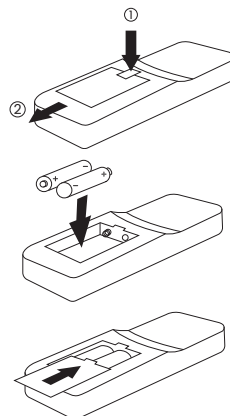

- The batteries supplied are used for checking whether the remote control is functioning normally. After confirming that the remote control functions normally, replace them with new batteries as soon as possible.
- Precautions for using the battery:
  - Insufficient battery power will affect the normal operation. If this happens, replace with new batteries. It is recommended to replace the batteries every 12 months.
  - Improper use of batteries may cause leakage or explosion. Please read the battery precautions carefully and use it with caution.
  - If battery fluid gets into your eyes, rinse with clean water immediately and seek medical attention.
  - If battery fluid gets on your skin or clothing, rinse it off with clean water.
  - Do not place batteries near a fire source, in direct sunlight or in a place where the temperature is higher than 60°C.
  - Do not place batteries in water or on wet surfaces.
  - Do not disassemble, strike or modify the battery. Otherwise it may cause the danger of short circuit of the battery.
  - Never recharge a non-rechargeable battery or dispose of a battery in a fire as it could be dangerous.
  - When the batteries are depleted or the ceiling light will not be used for a long time, remove the batteries to avoid damage to the remote control due to leakage of chemical substances in the batteries.
  - In order to reduce the possible harm of waste batteries to the environment and human health, dispose of waste batteries properly following local regulations on environmental protection and recycling.

## Signal Emission of the Remote Control

When using the remote control, point the Infrared signal transmitter at the front of the remote control to the Infrared signal receiver on the ceiling light.



### Precautions for using the remote control:

- Turn on the wall switch before using the remote control.
- The remote control signal has no signal channel, and a single remote control can be used to operate multiple ceiling lights.
- If there is an obstacle blocking the signal transmission between the ceiling light and the remote control, it may cause the ceiling light to work abnormally. To avoid such situation, pay attention to whether there is any obstacle blocking the signal transmission when operating the remote control.
- If the infrared signal transmitter on the remote control and the Infrared signal receiver on the ceiling light are dirty, it will affect the normal operation. If this happens, clean them with a clean and dry cloth.
- The operating distance of the remote control may be shortened due to the color or material of the ceiling, wall and floor.
- If there is a TV or wireless device controlled by Infrared remote controls near the ceiling light, it may affect the normal operation of the remote control.
- After using the remote control to turn off the ceiling light, the ceiling light still consumes less than 2W of electricity. Therefore, if the ceiling light will not be used for a long time, turn off the switch on the wall.

## Installing the Remote Control Holder

1. Clean the surface where the remote control will be installed.
2. Tear off the white adhesive tape on the back of the holder, then attach the holder to the surface to be installed. Press the holder firmly for 30 seconds and then let it stand for 1 hour.
3. Attach the remote control to the holder.



**It is not recommended to install the remote control holder on rough and uneven wall surfaces (it will cause weak adhesion) or wallpaper (it may damage the wall when removed).**

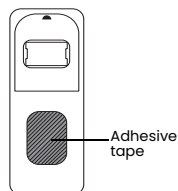

## Remove the Remote Control Holder

1. Remove the remote control.
2. Hold the holder (1) gently with the palm of your hand, and then slowly turn the holder to the left or right (2) to remove it.

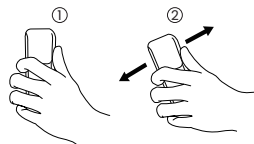

## Remote Control Functions

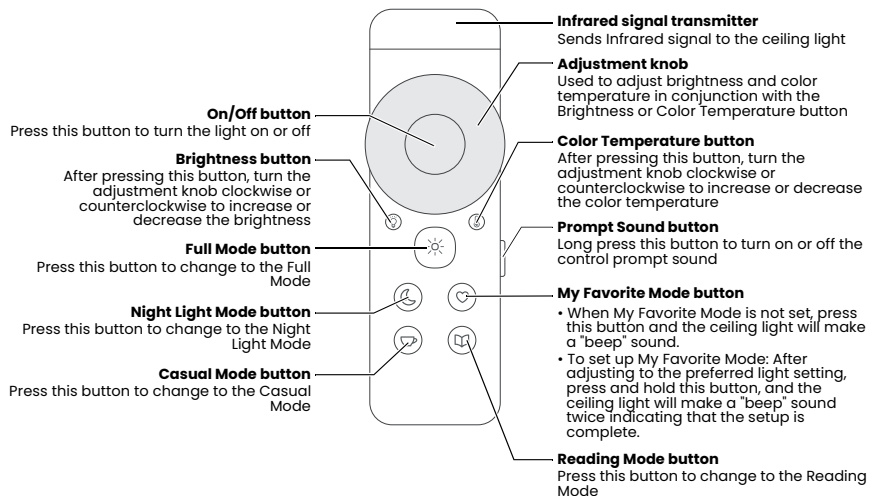

## Using the BenQ SmartLighting APP

### Downloading and Installing the BenQ SmartLighting APP

Search for "BenQ SmartLighting" in GooglePlay or AppStore according to the type of mobile device you are using, or scan the QR code on the right to download and install the BenQ SmartLighting APP:

After the installation is complete, tap the



icon to open

the BenQ SmartLighting APP.

### Using the BenQ SmartLighting APP

After opening the BenQ SmartLighting APP for the first time, the screen will guide you step by step through the procedures of adding a ceiling light and connecting to a wireless network. Follow the on-screen instructions to proceed.



- **The ceiling light only supports 2.4GHz Wi-Fi and does not support the 5GHz band. Please ensure that your mobile device and Wi-Fi router are connected to the same 2.4GHz network.**
- **When using the BenQ SmartLighting APP to operate the ceiling light, make sure that the wall switch is in the ON position.**

For the detailed operation and setting guide of the various functions provided by

the BenQ SmartLighting APP, tap the  icon on the upper left of the screen.



## Maintenance and Troubleshooting

- When performing maintenance and cleaning, be sure to turn off the mains power and wall switch first to avoid accidents of electric shock or conduction.
- Turn off the ceiling light first, and then use a soft, lint-free cloth dampened with diluted neutral detergent to wipe the light body. Never use volatile liquids or any other kind of chemical solvents such as kerosene, spot remover oil, etc., as they may damage the outer casing of the light.
- It is strictly forbidden to rinse the body and parts of the light directly with water or any liquid.
- If the light cannot be turned on, check whether the mains power and the wall switch are in the on position, and whether the ceiling light is installed correctly.
- If the problem still persists, stop using the light and contact the original place of purchase immediately.

# Specifications

Model	CL20
AC power input	100-240V AC , 50/60Hz
Max. power consumption	Max. 150W
Rated current/Power factor	Max. 1.5A/0.95
Color rendering index	≥95
Dimensions	59.2 x 59.2 x 11.2 cm
IP classification	IP20 (IP50 for the light enclosure only)

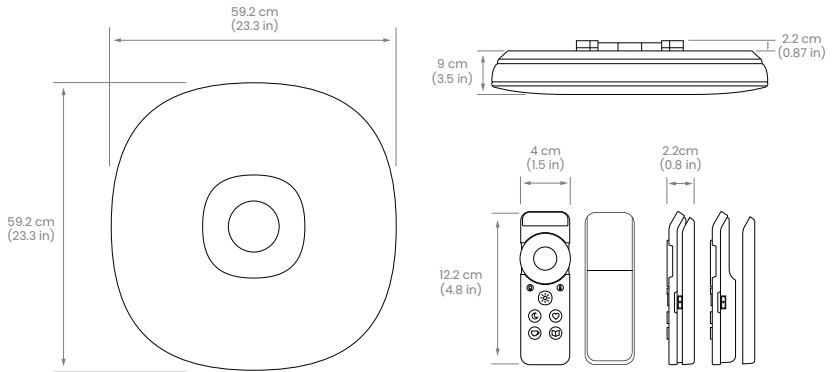

## 包裝內容

請檢查產品包裝中是否含有下列物品。若有損壞或短缺，請即刻連絡原購買處。

- 吸頂燈：1 台
- 上引掛器模組（黑色引掛器 + 鐵片）：1 個
- 下引掛器（白色）：1 個
- 遙控器：1 個
- 遙控器壁掛架：1 個
- 尖尾長螺絲：2 個
- 平尾短螺絲：2 個
- 白色塑膠膨脹螺絲：2 個
- AAA（4 號）電池：2 顆
- 快速使用指南：1 份
- 保固書：1 份



本說明書中的產品圖示可能會與您購買的產品有些許差異，請以您所購買機型的實際外觀為準。

## 安全注意事項

本產品已通過照明設備之安全標準檢驗。為確保您使用本產品之安全，請遵照以下安全注意事項，適切使用本產品。

- 本產品適用電源規格為 100-240V AC、50/60Hz，請使用原廠專用上引掛器與下引掛器，使用其它非專用引掛器可能造成產品損壞。
- 本產品適用溫度為攝氏 5-40 度，環境溫度過高或使用時間過長時，會縮短產品壽命。
- 請拆除本產品附帶的包裝材料後使用。若本產品包裝材料未完全拆除，使用時可能會引發火災。
- 本產品光源無法由使用者自行更換，一旦需要更換光源（如光源壽命終了時），請聯絡製造商或其服務代理商進行更換。
- 開燈時請勿將手伸到本產品後方，以防止高溫燙傷。
- 長時間不使用本產品時，請關閉電源開關或牆壁開關。
- 依據天花板的材料和結構，安裝本產品的天花板表面可能會變色。
- 避免在溫泉區等產生腐蝕性氣體的場所使用本產品。
- 由於本產品零部件的膨脹和收縮，在開燈期間或剛關閉後可能會發出聲音。
- 在本產品燈光下，當您使用照相機或攝影機拍攝時，顯示器或拍攝的影像上可能會出現線條或圖案。
- 請勿擅自拆解本產品的任何零組件，以免產生觸電意外或毀損零組件和運作功能。
- 請勿將會發熱的電器或設備（例如暖爐或火爐）置於本產品的正下方，以免發生火災。
- 本產品在長時間使用後表面溫度會升高。若須擦拭清潔本產品表面，請將本產品電源關閉，並待其冷卻後再進行。



### 注意

- 若遇到以下情況，請立即切斷電源，並向授權之維修代理商或合格技術人員尋求支援：
  - 本產品的外殼破損時。
  - 本產品散發異常氣味時。
  - 本產品在啟動狀態，卻出現 LED 燈源異常閃爍情況時。
  - 電線破損、或電線內部線材裸露時。
- 請勿將本產品安裝在潮濕環境（例如浴室、戶外），以免造成電線短路和意外事故。
- 本產品僅適用於室內，切勿安裝在戶外使用。
- 嚴禁拆解本產品的任何部分或零組件，否則可能造成意外，並讓產品保固失效。

- 取得審驗證明之低功率射頻器材，非經核准，公司、商號或使用者均不得擅自變更頻率、加大功率或變更原設計之特性及功能。低功率射頻器材之使用不得影響飛航安全及干擾合法通信；經發現有干擾現象時，應立即停用，並改善至無干擾時方得繼續使用。前述合法通信，指依電信管理法規定作業之無線電通信。低功率射頻器材須忍受合法通信或工業、科學及醫療用電波輻射性電機設備之干擾。

- 本產品內含射頻模組，其 NCC 型式認證號碼為：



CCAK21Y10020T0

## 各部位名稱與功能

### 安裝用零件

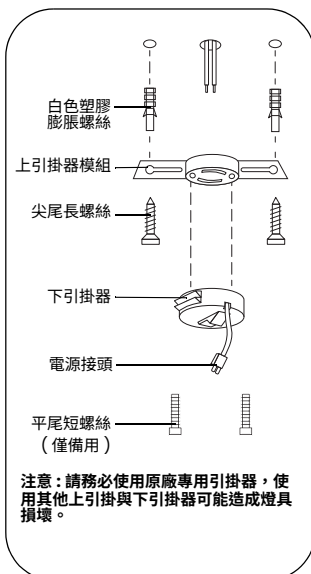

### 吸頂燈本體

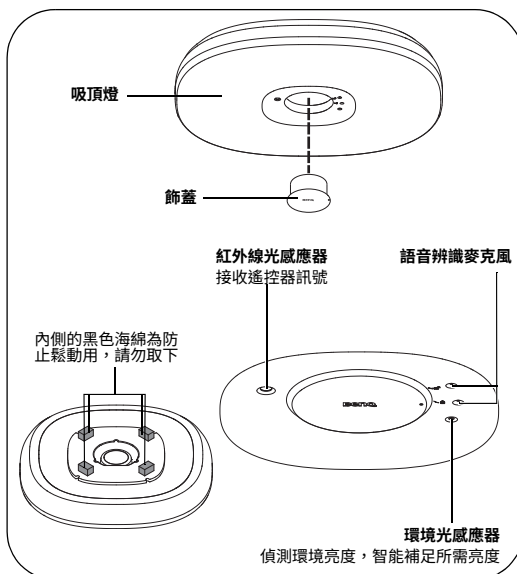

### 遙控器與附屬配件

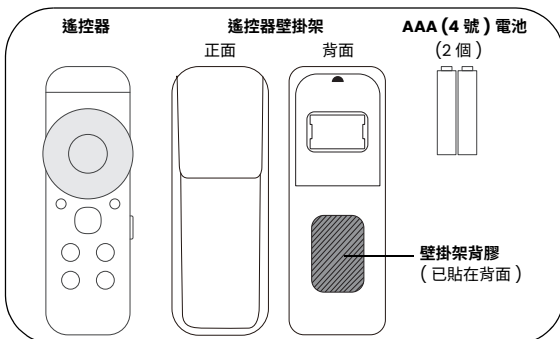

## 安裝吸頂燈

### 安裝前的注意事項

- 本產品請務必由專業的電器施工人員進行安裝，並且穿戴適當的施工與防護用具。
- 安裝本產品前，請務必先關閉電源總開關以及壁面開關，以免發生電擊或導電意外。
- 請勿安裝在不結實的天花板（如膠合板或石膏板），避免掉落造成人員受傷。
- 請確認使用原廠引掛器，原廠以外的引掛器均無法使用，也不可將其它燈具（包含下引掛器）安裝在此產品的引掛器上。請諮詢電器行、水電行專業人員安裝原廠引掛器。
- 安裝本產品時若需使用梯子，請務必注意梯子穩固度，避免梯子傾倒而發生危險。

- 安裝本產品時若需使用延長線（電動工具用），請務必注意它的可延伸長度，避免安裝人員被延長線絆倒而發生危險。
- 本產品指定的電源規格為 100-240V AC，50/60Hz。
- 本產品僅限安裝於水平且平整的天花板表面上。請勿將本產品安裝在傾斜或不平整的天花板表面上（例如船底 / 傾斜形狀天花板、格柵天花板或隔板天花板、凹凸或有極端突出物的天花板），以免因為無法確實固定而掉落並造成危險。

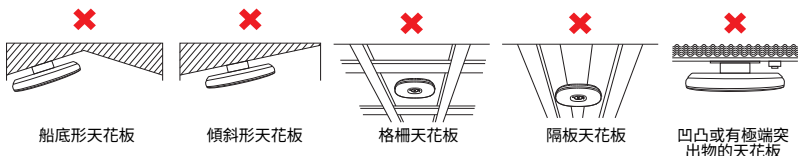

- 請務必使用本產品隨附的安裝配件將本產品確實安裝在天花板表面，並確保天花板足以承受本產品的重量（約 4.1 公斤）。切勿將本產品鎖附在裝潢薄板上（例如沒有加固的天花板、膠合板或石膏板），或僅使用黏膠將吸頂燈黏附在天花板表面上，以免因為無法確實固定而掉落並造成危險。

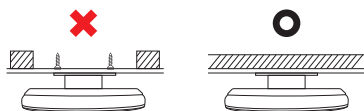

- 請確保上引掛器的安裝位置與四周牆面間留有至少直徑 84 cm 以上的空間，以確保理想的燈光效果。

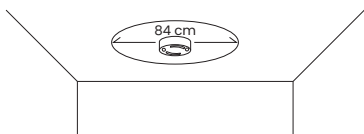

- 本產品必須配合非調光式的壁面開關使用。若壁面開關為調光式的開關，請委託專業水電人員更換為非調光式壁面開關，防止操作異常。

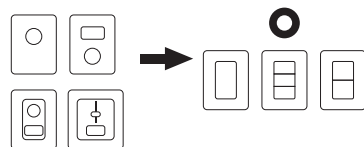

- 若使用場域設有整流照明器具時，請於安裝時與整流照明器具之間預留 150 cm 的緩衝空間。

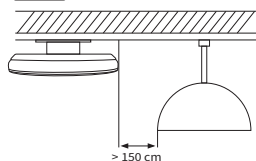

- 下列情況下，請勿安裝上引掛器，請聯繫 BenQ 客服中心更換：

- 上引掛器破損
- 上引掛器鬆動
- 上引掛器已安裝在隔板天花板上

- 請勿用紙質或布質器具包覆引掛器，以防止火災發生。

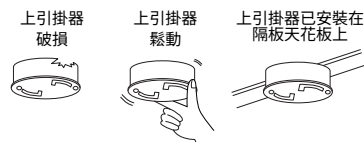



## 上、下引掛器的安裝

安裝引掛器前請務必先關閉電源開關以及壁面開關，以免發生電擊或導電意外。請務必遵循以下安裝步驟，避免安裝不確實造成燈具掉落危險。

1. 將上引掛器模組連接至 AC 電源 (100-240V AC、50/60Hz)，中性線及火線適用線徑為 1.6-2.0 mm、剝皮長度須介於 10-12mm 之間，且為單芯線。接著將中性線接於左上有 "W" 標示處，火線接於右下無標示處。請確認已確實將電線插到底，不可裸露出銅線，且中性線與火線連接牢固而無鬆動情況。

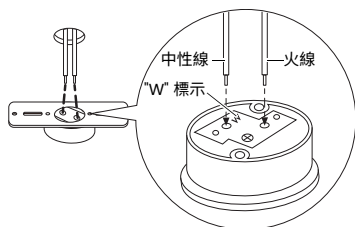

2. 使用兩根尖尾長螺絲加上塑膠螺栓，將上引掛器模組（上引掛器 + 鐵片）鎖附在天花板表面上。

 注意：

- 請勿將上引掛器模組安裝在接線盒上，以防止掉落風險。
- 請勿使用舊有孔洞安裝上引掛器模組。安裝時請務必重新打孔，以防止掉落風險。

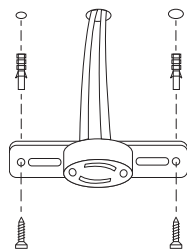

3. 將下引掛器上的兩個金屬勾對準並插入上引掛器的兩個方形孔內 (1)，然後將下引掛器向右（順時針），即綠色

方向旋轉到底 (2)，直到下引掛

器紅色按鈕位置對齊上引掛器紅色定位貼紙 (3)，此時若聽到一聲「喀」聲，表示下引掛器已安裝到定位。若沒有聽到「喀」聲，或下引掛器安裝後有鬆動現象，請檢查金屬勾是否都已確實插入方形孔內。

 注意：若沒有聽到「喀」聲，或下引掛器安裝後有鬆動現象，請聯繫客服中心進行檢查。

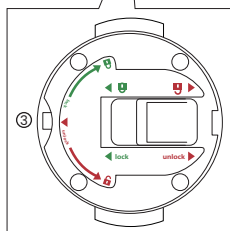
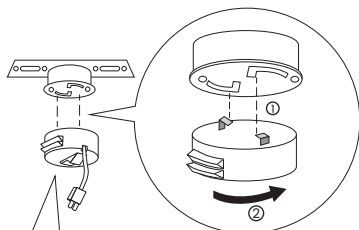

## 吸頂燈的安裝

●請依照順序正確安裝，以防燈具掉落造成人員受傷。

1. 取下吸頂燈中央的飾蓋：將飾蓋逆時針旋轉，聽到「喀」一聲 (1)，確認飾蓋的凹點對齊解鎖符號 (2)，此時即可將飾蓋拉下 (3)。

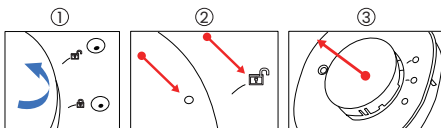

2. 將吸頂燈中央的安裝孔對準下引掛器，使下引掛器上的電源線穿過安裝孔 (1)，然後將吸頂燈向上推到底。此時若聽到「喀」「喀」兩聲，表示吸頂燈已確實安裝到定位。

●注意：請確認燈具本體安裝情況，確認不可有下列情況發生：

本體輕易搖晃

本體容易旋轉

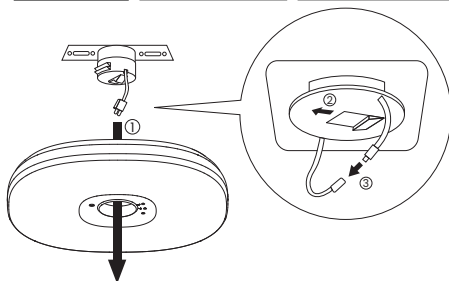

3. 請一手扶著吸頂燈，另一手用拇指將下引掛器上的綠色滑鈕往綠色◀lock，即圖示 (2) 之方向滑動到底以鎖定卡榫，以避免掉落風險。
4. 將下引掛器上的電源線連接至吸頂燈的電源接頭 (3)，確認電源線連接牢固，無鬆脫的現象。
5. 將飾蓋順時針旋轉裝回：將飾蓋的凹點對齊上方的解鎖符號 (1)，將飾蓋往上推到底，確定飾蓋可旋轉但且不會掉落，然後將飾蓋順時針旋轉聽到「喀」一聲 (2)，確認飾蓋的凹點對齊鎖定符號 (3)。
6. 調整燈體角度並測試清潔燈罩。

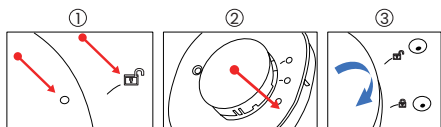

## 拆卸吸頂燈

若因清潔或維修之需要而需拆卸，請依照以下說明進行。

### 拆卸前的注意事項

- 若需使用梯子，請務必注意梯子穩固度，避免梯子傾倒而發生危險。
- 請務必先關閉電源總開關以及壁面開關，以免發生電擊或導電意外。

### 吸頂燈的拆卸

1. 取下吸頂燈中央的飾蓋：將飾蓋逆時針旋轉，聽到「喀」一聲 (1)，確認飾蓋的凹點對齊解鎖符號 (2)，此時即可將飾蓋拉下 (3)。

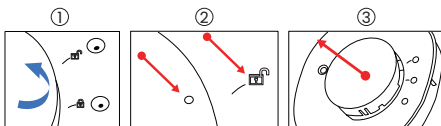

2. 以手指將電源線接頭上的固定勾柄向下壓 (1)，同時拔開電源線接頭 (2)。
3. 以雙手扶持住吸頂燈，同時用拇指將下引掛器上的綠色滑鈕往紅色「lock」▶，即圖示 (3) 之方向滑動到底以解除卡榫的鎖定。此時吸頂燈會從下引掛器解除固定，請緩緩將吸頂燈取下，並放置在乾淨、穩固的平面上。

**注意：**請務必以雙手支撐吸頂燈後，再解除卡榫鎖定，以防燈具掉落造成人員受傷。

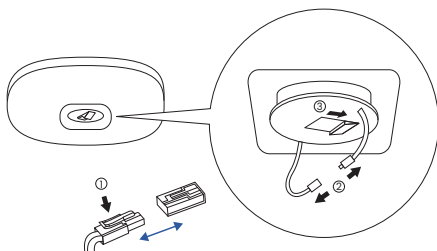

## 下引掛器的拆卸

若須拆卸下引掛器，請在拆卸吸頂燈後，以手指按住下引掛器上的紅色按鈕 (1)，同時將下引掛器向左 (

逆時針)，即紅色

方向旋轉

(2)，即可將之拆下。

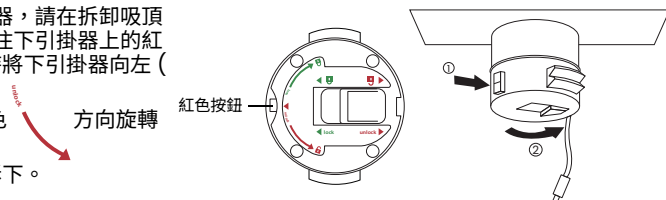

## 使用吸頂燈

### 吸頂燈的燈光模式

本吸頂燈提供四種燈光模式與可以客製化燈光設定的「我的最愛」：

燈光模式	設定			備註
	色溫	亮度	亮燈區域	
全燈模式	4000K	100%	主光源 + 間接光源	在此模式下，可手動同時調整主光源與間接光源的亮度與色溫（調整時，會退出全燈模式）
休閒模式	3000K	自動根據周圍環境亮度最佳化	間接光源	在此模式下，可手動調整間接光源的亮度與色溫（調整時，會退出休閒模式）
閱讀模式	4500K		主光源 + 間接光源	在此模式下，可手動調整主光源與間接光源的亮度與色溫（調整時，會退出閱讀模式）
夜燈模式	1800K	10 段可調整（預設為第 5 段）	夜燈	僅可調整亮度
我的最愛	<ul style="list-style-type: none"> <li>尚未設定我的最愛時，按下遙控器上的「我的最愛」按鍵，吸頂燈會發出「嗶」一聲。</li> <li>設定我的最愛：調整至喜好光線設定後，長按遙控器上的「我的最愛」按鍵，吸頂燈會發出「嗶嗶」兩聲，即完成設定。</li> </ul>			

### 吸頂燈的操作方式

您可以透過以下四種操作方式使用吸頂燈：

- 使用壁面開關操作（僅部分功能）
- 使用遙控器操作（僅部分功能）
- 使用語音控制操作（僅部分功能）
- 使用 BenQ SmartLighting APP 操作（完整功能）

## 使用壁面開關操作

您可以使用壁面開關打開或關閉吸頂燈的電源，或將吸頂燈的亮燈模式在「我的最愛」、「休閒模式」與「夜燈模式」間循環切換。若要切換吸頂燈的亮燈模式，請使用壁面開關在 3 秒內關閉後再打開電源。重複此關閉、開啟之操作即可再切換至下一個亮燈模式。

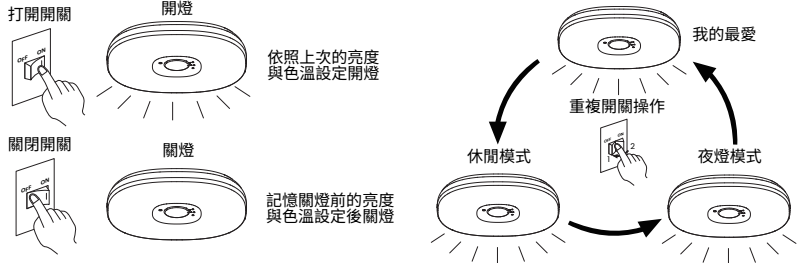

- 在壁面開關電源開啟狀態下，若電源供應突然中斷，吸頂燈會在電源恢復後自動回復斷電前的設定。
  - 如斷電前吸頂燈為開啟狀態，供電後吸頂燈會自動點亮，並記憶斷電前的亮度與色溫。
  - 如斷電前吸頂燈已使用其它控制方式（APP / 語音 / 遙控器）關閉，供電後吸頂燈會保持關閉，您須使用其它控制方式（APP / 語音 / 遙控器）或是在 3 秒內切換壁面開關兩次來開啟吸頂燈。
- 請勿以單一牆壁開關操作兩台以上燈具，可能發生無法同時切換的情況。

## 使用遙控器操作

### 安裝電池

請將隨附的兩個 AAA（4 號）電池裝入遙控器中。裝入電池時，請務必確認電池的正負極性與遙控器上的標示相符。

1. 打開遙控器背蓋。按住遙控器背蓋的箭頭指示 (1)，然後往下滑動打開背蓋 (2)。

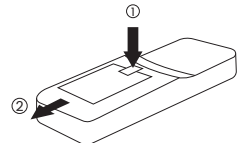

2. 裝入 2 顆 4 號電池，請依照電池槽的正負極指示裝入電池。

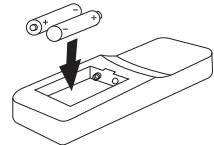

3. 往上滑動關閉背蓋。

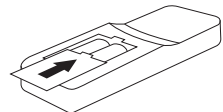

- 本產品隨附的電池為確認遙控器功能是否正常之用。在確認遙控器功能正常後，請儘速將之更換為全新的電池。

### 電池使用時的注意事項：

- 電量不足會影響正常操作，若有此情況請更換新電池。建議每 12 個月更換一次遙控器中的電池。
- 電池使用不當可能導致漏液或爆炸。請仔細閱讀電池注意事項並謹慎使用。
- 如果電池液進入眼睛，請立即使用清水沖洗並就醫。
- 如果電池液沾到皮膚或衣服上，請用清水沖洗乾淨。
- 請勿將電池靠近火源、將電池放置於太陽直射處或溫度高於 60°C 之場所。
- 請勿將電池放置於水中或潮溼之場所。
- 請勿拆解、敲擊或改裝電池，否則易導致電池短路發生危險。
- 切勿將用完的非充電式電池充電、或將電池棄於火中，以免發生危險。

- 當電池已耗盡或長時間不使用本產品時，請將電池取出，以免因電池內的化學物質滲漏導致本產品損壞。
- 為降低廢電池對環境、人類健康的可能危害，請配合當地環保回收相關法規，透過回收管道處理廢電池。

### 遙控器的訊號感應

在使用遙控器時，請將遙控器前端的紅外線訊號發射器指向吸頂燈上的遙控訊號接收器再進行操作。

#### 遙控器使用時的注意事項：

- 使用遙控器前，請打開牆壁開關。
- 遙控器無訊號頻道，可使用單支遙控器操作多盞吸頂燈。
- 吸頂燈與遙控器之間若有阻礙訊號障礙物時，可能造成吸頂燈無法正常作動，為避免上述情況，請注意操作遙控器時是否有阻礙物妨礙訊號傳輸。
- 遙控器上的紅外線訊號發射器與吸頂燈上的紅外線光感應器若有髒污情況，會影響正常操作。若有髒污情況請以乾布擦拭乾淨。
- 遙控器操作距離會因天花板、牆壁、地板顏色或材質而產生縮短的情況。
- 吸頂燈附近若有使用紅外線遙控器的電視機或無線機器時，可能會影響本遙控器正常操作。
- 使用遙控器開燈後，吸頂燈仍會消耗 2W 以下的電力。因此若長時間不使用吸頂燈，請關閉牆上開關。

### 安裝遙控器壁掛架

1. 請先將欲黏貼的表面清潔乾淨。
2. 撕下壁掛架背面之背膠上的白色膠紙，然後將壁掛架貼附在欲黏貼的表面上，施力按壓 30 秒後靜置 1 小時。
3. 將遙控器吸附於壁掛架上。

● 不建議將遙控器壁掛架黏貼在粗糙不平整的牆面（會導致黏貼不牢固）或壁紙上（移除時可能會破壞牆面）

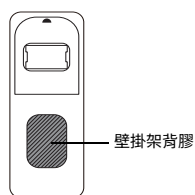

### 取下遙控器壁掛架

1. 請先取下遙控器。
2. 以手掌輕握壁掛架 (1)，然後緩緩將壁掛架向左或向右旋轉 (2)，即可將壁掛架取下。

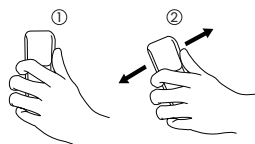

### 遙控器的各項功能

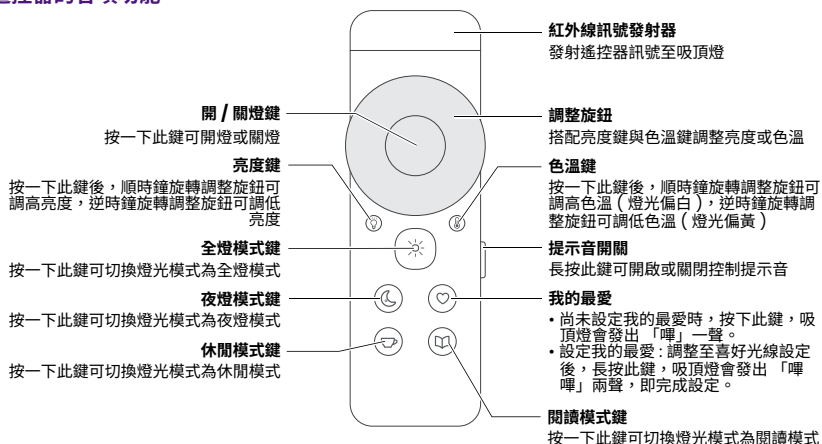

## 使用語音控制操作

本吸頂燈的語音控制功能預設為啟用狀態。若要使用語音控制功能操作吸頂燈，請依照以下步驟進行：

1. 請先對著吸頂燈說出喚醒詞「小 Q 小 Q」。若吸頂燈成功辨識您所說出的喚醒詞，則會發出一聲「嗶」聲的提示音回應。
2. 請緊接著說出語音指令。若吸頂燈成功辨識您所說出的語音指令，就會執行相對的功能。

本吸頂燈支援的語音指令請見下表：

開 / 關燈操作				
開燈 把燈打開	關燈 把燈關掉			
調整亮度				
調到最亮	調到最暗	調亮一點	調暗一點	
調整色溫				
調到最暖 調到最黃	調到最冷 調到最白	調暖一點 調黃一點	調冷一點 調白一點	
選擇燈光模式				
全燈模式	閱讀模式	休閒模式	我的最愛	夜燈模式
N 分鐘後開 / 關燈				
N 分鐘後開燈 (N = 1、2、3、4、5、10、15、20、25、30)				
N 分鐘後關燈 (N = 1、2、3、4、5、10、15、20、25、30)				

 建議依照上表語音指令進行控制，可得到最佳體驗效果。

例如：

- 若您想調高燈的亮度，請說：「小 Q 小 Q」 $\xrightarrow{\text{間隔 1~2 秒}}$ 「調亮一點」。
- 若您想讓燈在 20 分鐘後自動關閉，請說：「小 Q 小 Q」 $\xrightarrow{\text{間隔 1~2 秒}}$ 「20 分鐘後關燈」。
- 若您想連續操作多個功能，請說：「小 Q 小 Q」 $\xrightarrow{\text{間隔 1~2 秒}}$ 「調暗一點」 $\xrightarrow{5 \sim 8 \text{ 秒內}}$ 「調暖一點」。

-  • 喚醒詞與語音指令間若間隔太短，可能影響正常操作。
- 若關閉提示音，喚醒詞與語音指令間請間隔 1~2 秒。
- 語音指令間隔 5~8 秒內可連續操作。
- 使用語音控制功能前，請先確認壁面開關在打開的位置。
- 使用喚醒詞與語音指令時，請保持正常的說話速度與音量。
- 您可在 BenQ SmartLighting APP 中關閉 / 開啟語音控制功能。

## 使用 BenQ SmartLighting APP 操作

### 下載與安裝 BenQ SmartLighting APP

請依據您使用的行動裝置種類，在 GooglePlay 或 AppStore 中搜尋「BenQ SmartLighting」，或掃描右方的 QR 碼以下載並安裝 BenQ SmartLighting APP：

在完成安裝後，點選



APP。



### 使用 BenQ SmartLighting APP

在第一次開啟 BenQ SmartLighting APP 後，畫面將會逐步引導您完成新增吸頂燈與連接無線網路的程序。請依照畫面上的指示進行。

- 本吸頂燈僅支援 **2.4GHz Wi-Fi**，不支援 **5GHz** 頻段。請確認您的行動裝置與 Wi-Fi 路由器皆連接至相同的 **2.4GHz** 網路。
  - 使用 BenQ SmartLighting APP 操作時，請先確認壁面開關在打開的位置。
- 關於 BenQ SmartLighting APP 所提供之各項功能的操作指南與詳細的

設定指南，請點選 BenQ SmartLighting APP 畫面左上方的 (?) 圖示。



## 一般保養與故障診斷

- 進行保養清潔時請務必先關閉電源開關以及壁面開關，以免發生電擊或導電意外。
- 請先將燈關閉，然後使用一塊柔軟、不掉棉絮的布沾上少許稀釋過的中性清潔劑擦拭燈本體。切勿使用揮發性液體或任何其它種類的化學溶劑，例如煤油、去漬油等，否則可能會損壞燈的外殼。
- 嚴禁使用水或任何液體直接沖洗燈的本體與部件。
- 若燈無法點亮，請確認電源總開關以及壁面開關是否在打開的位置，以及吸頂燈是否已正確安裝。
- 若仍然無法解決問題，請停止使用並洽詢原購買處。

## 規格

型號	CL20
AC 電源輸入	100-240V AC，50/60Hz
最大消耗功率	Max. 150W
額定電流 / 功率因數	Max. 1.5A/0.95
顯色指數	≥95
燈具本體尺寸	59.2 x 59.2 x 11.2 (cm)
IP 等級	IP20，僅燈罩符合 IP50

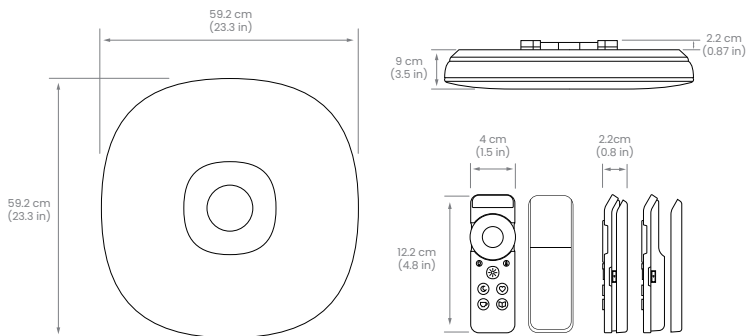

單元	限用物質及其化學符號					
	鉛 (Pb)	汞 (Hg)	鎘 (Cd)	六價鉻 (Cr <sup>+6</sup> )	多溴聯苯 (PBB)	多溴二苯醚 (PBDE)
金屬機構件	○	○	○	○	○	○
塑料機構件	○	○	○	○	○	○
電路板組件	○	○	○	○	○	○
電源線/其他線材	○	○	○	○	○	○
配件	○	○	○	○	○	○
備考 1. "○" 係指該項限用物質之百分比含量未超出百分比含量基準值。						
備考 2. "—" 係指該項限用物質為排除項目。						