



# Digital Projector Quick Start Guide

Gaming Projector | X3100i

BenQ PN: 4J.JS901.003\_V2.00

© 2024 BenQ Corporation. All rights reserved. Rights of modification reserved.

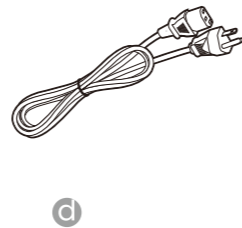
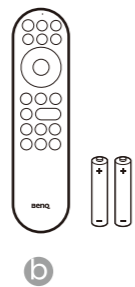
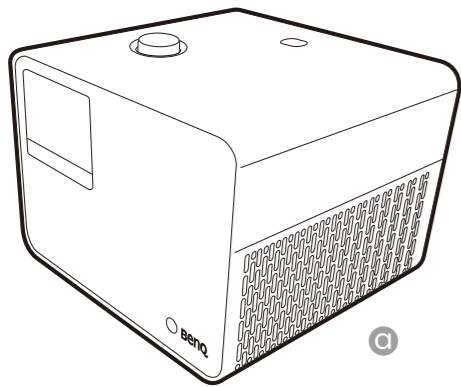

Quick start guide



Regulatory statements



Warranty card  
(varies by region)

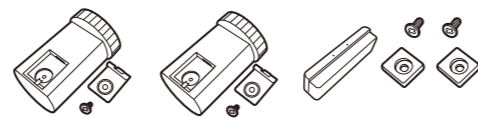

Adjustment feet kit  
(for upside down projection)

## Setup

1

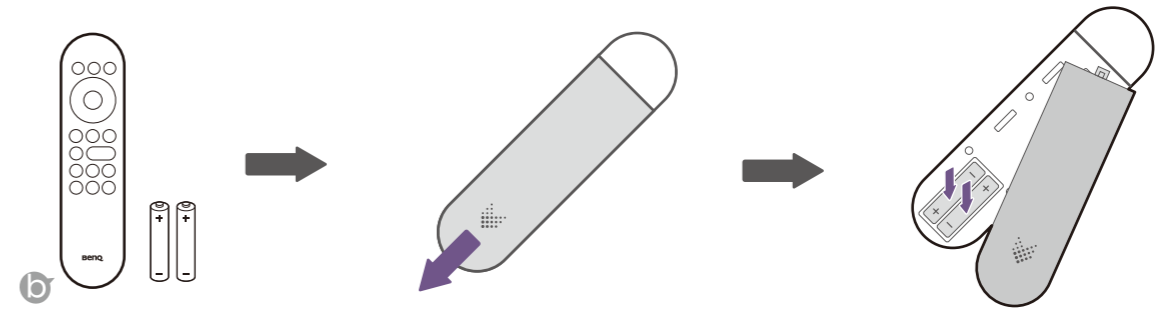

2

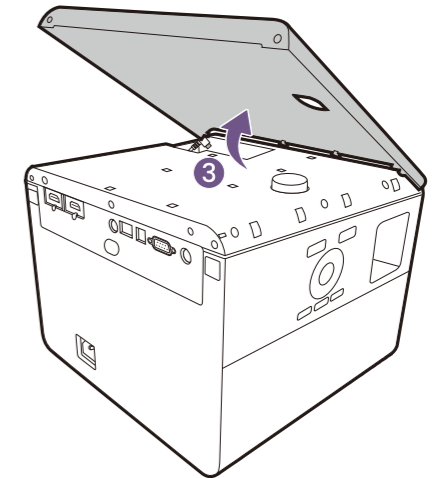
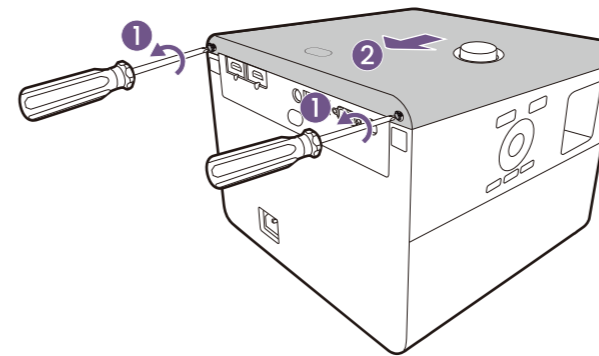

3

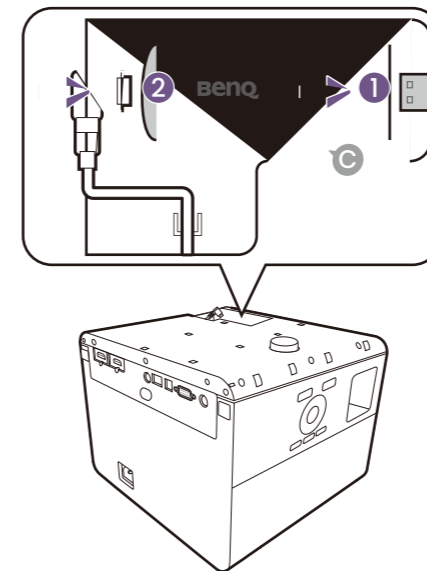

4

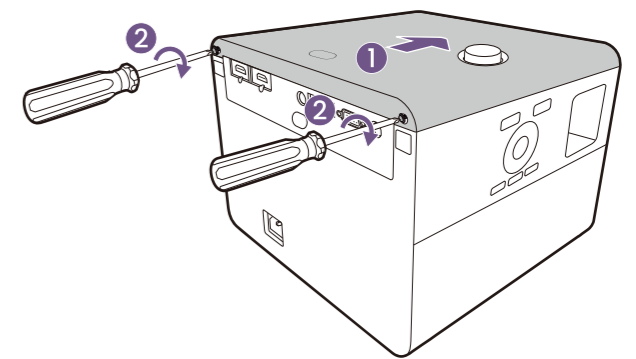

5

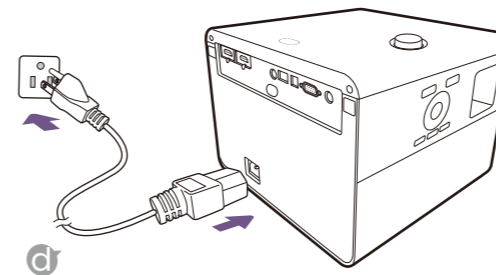

6

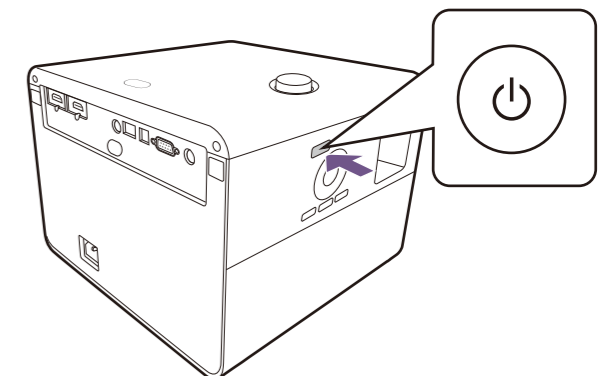

## Image adjustments

Image zoom

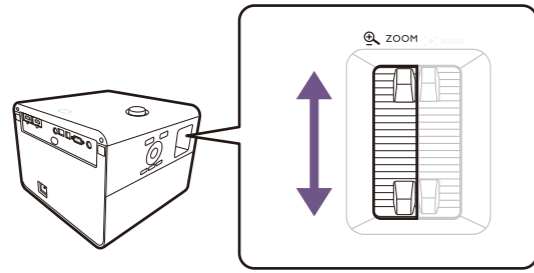
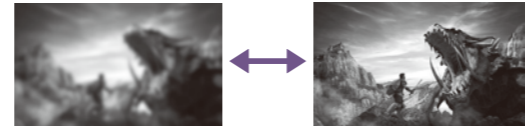
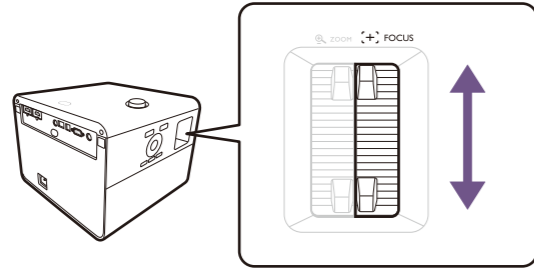
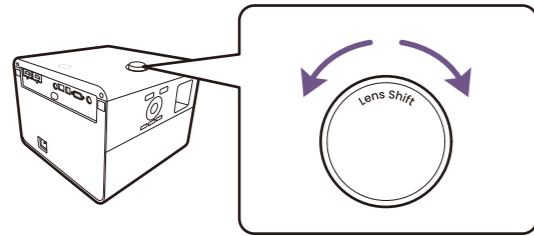

Image focus



Lens shift



Now, game is on!  
Get Awed by Details

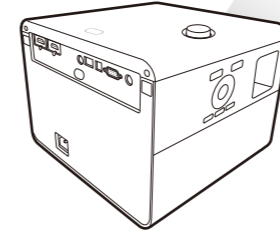

## Projector placement

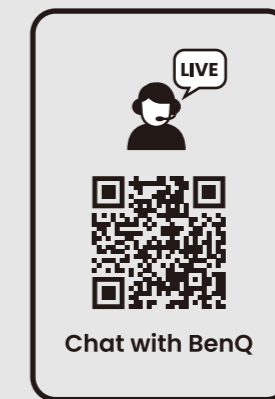
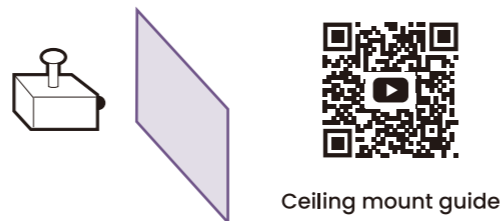

## Video connection

1

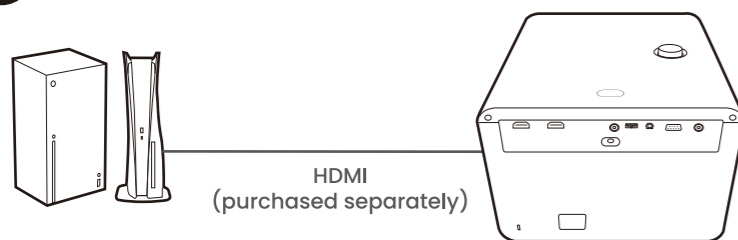

2

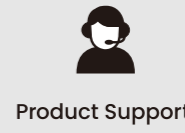
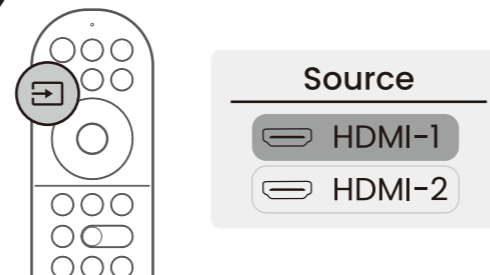

Warranty Information

Online Manual

Product Support

Software Download

X3100i  
SettingXchange

SettingXchange